

Space Heater Control Panel Functions

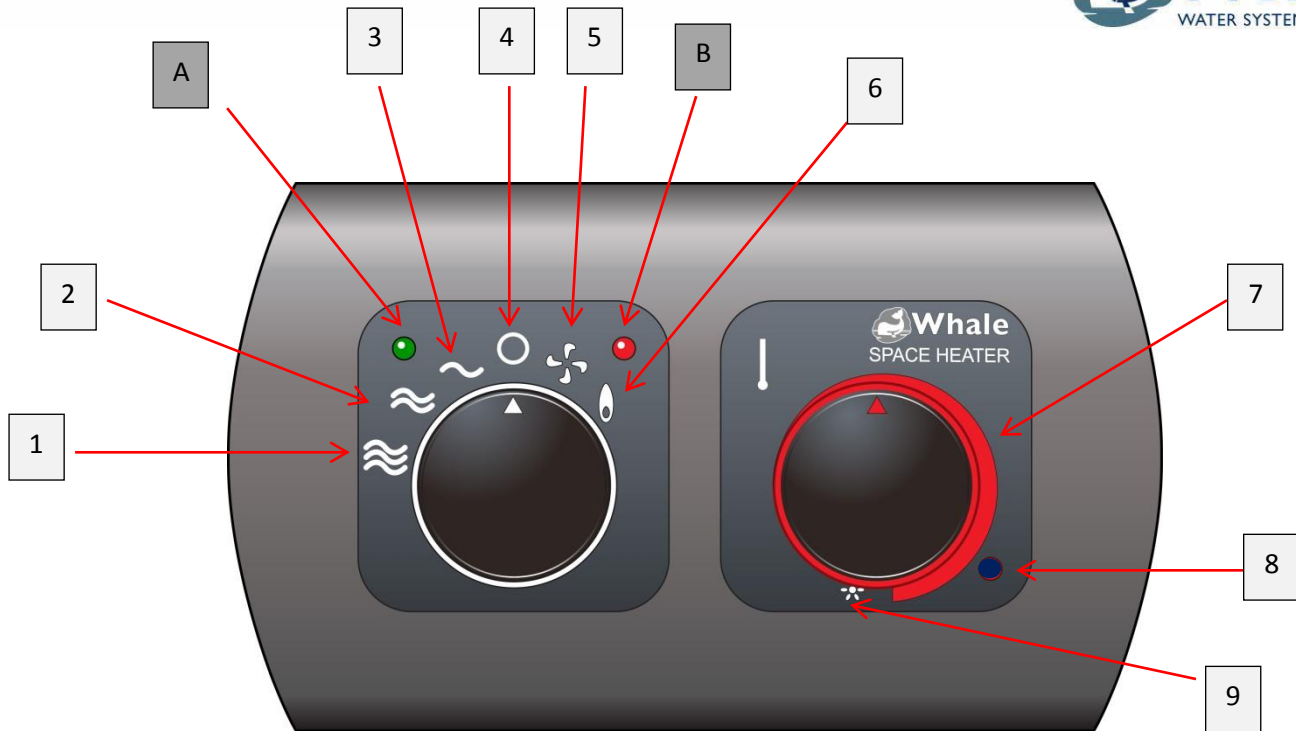

A	Gas Setting – Green LED	When lit, indicates that the heater is operating on gas.
B	Diagnostic Indicator – Red LED	Will flash if heater has failed to turn on due to a fault, under normal operation this light will remain turned off
1	2000W	Heat boost electric setting
2	1000W	Intermediate heat electric setting
3	500W	Quiet / night time electric setting
4	Off	Heater off position
5	Fan only	Air circulation setting, no heat output
6	Gas function	Gas only setting
7	Thermostat	Used to adjust the temperature in the van when the heater is on.
8	Temperature Sensor	Note – this is not an LED and does not light up
9	Low heat output level	Frost protection setting

- NOTE:
1. When operating on gas the green LED will be lit to show that the gas is burning safely.
 2. When operating on electric the fan will be running and heat generated, but no LED's will be lit.